



Checkpoints

VIRGINIA MOTOR SPORT CLUB

VOLUME 26 NUMBER 3 MARCH 1981

ANOTHER

NOTICE

The March regular meeting, and the rest of the regular meetings for 1981 will be held on the THIRD Thursday of the month at 8:00 PM at Our Lady of Lourdes School, 8200 Woodman Road.

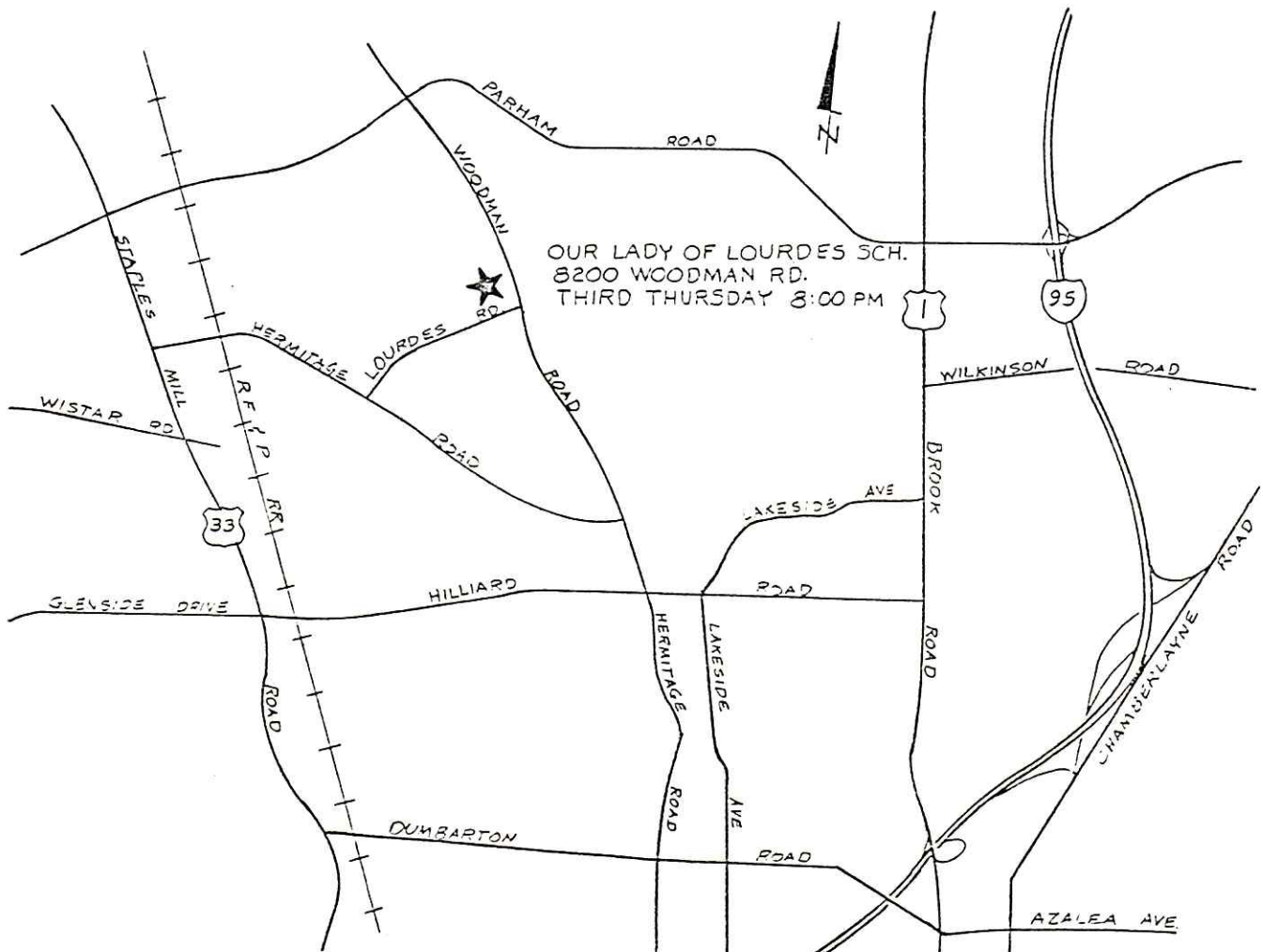

Richmond Honda Offers “More Miles Per Dollar”

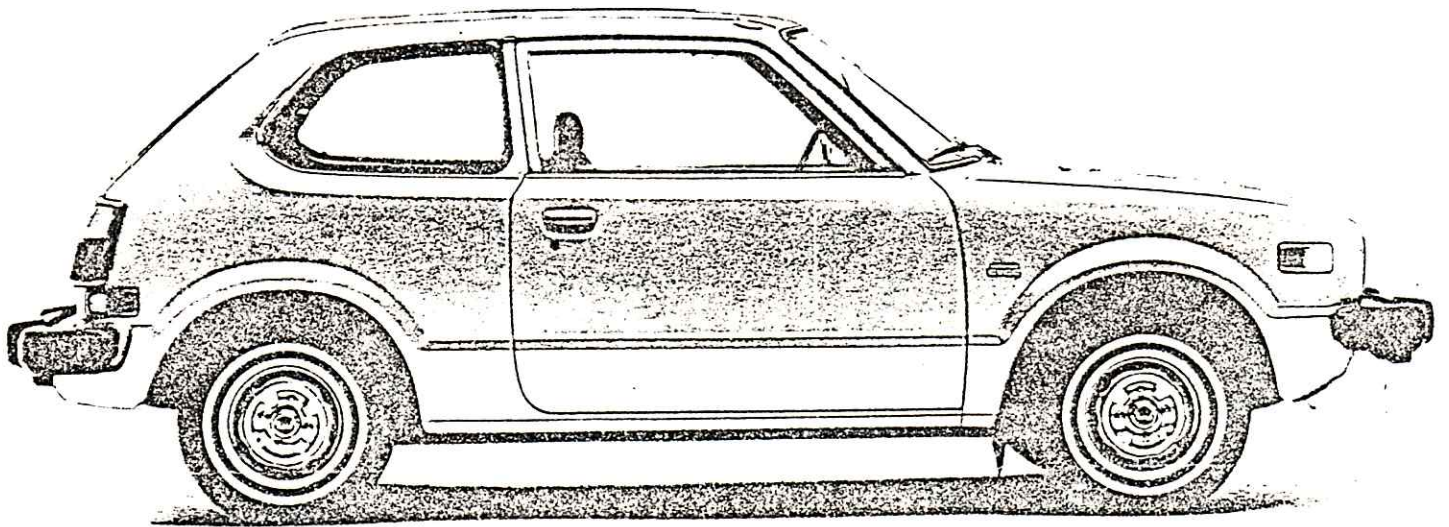

Be Happy, Go Richmond Honda

Your No.1 **HONDA** Dealer

7400 Midlothian Turnpike Richmond, Virginia 23225 804/745-0300



Presents...

WINTER CLOSE-OUT

March 15, 1981

Thalhimer Westmoreland
2000 Westmoreland St.
Richmond, Va.

Close-out winter with a fast and challenging autocross Oded by Bill Hunter and Ellis Wimmer. FUN RUNS FIRST to stretch your winter muscles and break the hibernation habit! \$1.00 each. Three Fun Runs allowed for each regular paid number registered, time permitting.

Registration and tech open at 9:00 a.m., first walk-thru at 9:15 a.m. First Fun Run at 9:30 a.m. Fun Runs without interruption until 11:45 a.m., then another walk-thru. First heat begins at 12:00 p.m. You'll be guaranteed at least one Fun Run but only if you register by 11:00 a.m.

Entry fee: \$5.00 for 3 runs. 1980 MWCSCC classes, modified to include camber compensation on swing-axle cars, and 1.75" minimum ground clearance. Exhaust suppression required.

For more info call Bill at (804) 883-6557.

NEW MEMBER

George L. Wright Jr.
1331 Huntland Rd.
Richmond, Va. 23225
320-8210

George, president of Merchant's Refridgeration, owns a 1970 TR6 and joined VMSC to meet people with interests similar to his of autocrossing and tinkering.

Nice to have you aboard, George.

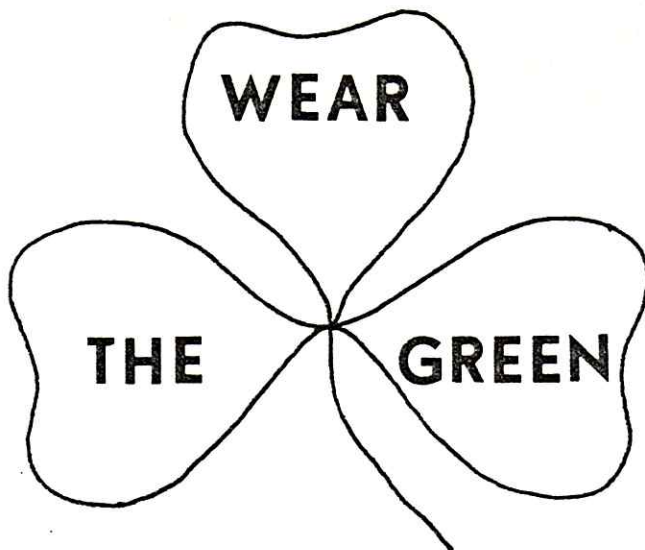

VMSC's FIRST EVER,
PINBALL TOURNAMENT
MARCH 26,
1981

AT "THE WIZARD" (FORMERLY VILLAGE STARSHIP) IN THE TUCKAHOE VILLAGE SHOPPING CENTER ON PATTERSON AVENUE 2.5 MILES WEST OF PARHAM. OPEN TO VMSC MEMBERS AND INVITED GUESTS. TOURNAMENT STARTS AT 8:00 P.M. (MACHINES WILL BE ANNOUNCED AT MARCH CLUB MEETING) VMSC MEMBERS WILL RECEIVE 60 TOKENS FOR A DOLLAR THAT NIGHT, SO YOU CAN SHOW UP EARLY FOR PRACTICE & GET A PRICE BREAK.

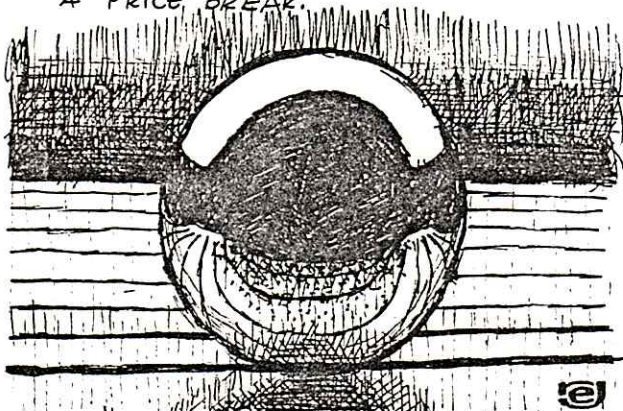

THE MANAGEMENT AT "THE WIZARD" WILL ALSO LET MEMBERS HAVE COCKES FOR ONLY A QUARTER, AND THEY HAVE A GREAT SNACK BAR WITH HOT & COLD SANDWICHES!

A \$3.00 ENTRY FEE WILL COVER THE COST OF THE SELECTED GAMES AND TROPHY EXPENSES. SEE YOU THERE!

to the

St. Patrick's Day Party

at the home of
Toby and Ruth Williams
6401 Lothaire Ct.

March 21, 1981
8:00 PM "until"

RSVP by 3/16
(275-1007)

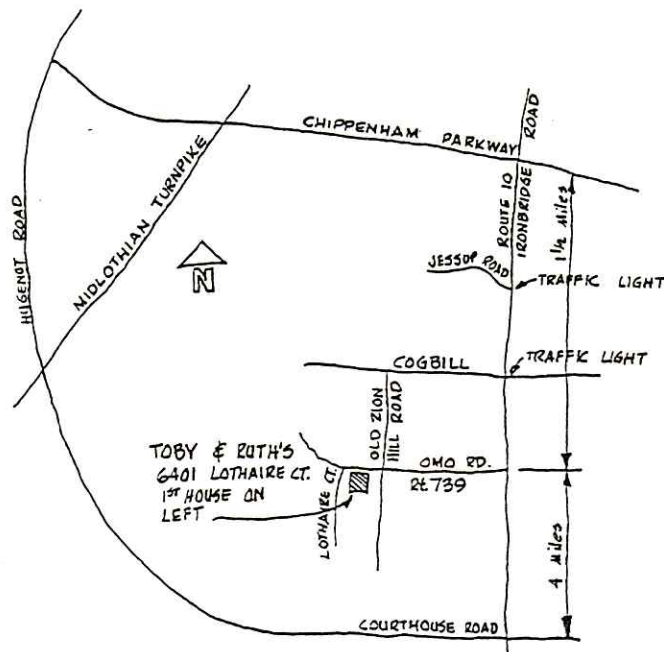

SCHEDULE OF EVENTS

- MAR 15 VMSC Autocross at Thalhimer's Westmoreland. See flyer in this issue. OD's Bill Hunter and Ellis Wimmer.
- MAR 19 VMSC monthly meeting at 8:00 PM at Our Lady of Lourdes School on Woodman Road.
- MAR 21 VMSC works at WCVE-TV's Festival '81. Contact Dick Jones (784-4373) for details or to volunteer assistance.
- MAR 22 ODZCC Autocross at Chesterfield Mall.
- MAR 29 VMSC Rally "Your Mother Would Like This Rally" by Rallymasters Gary Stout and Dick Jones. See flyer in this issue.
- APR 5 VMSC Autocross at Chesterfield Mall. OD's Libby Wells, Barbara Stout, and Shelia Hunter. See flyer in this issue.
- APR 11&12 Bob Ridges Memorial Rally near Luray, Va.
- APR 16 VMSC monthly meeting at 8:00 PM at Our Lady of Lourdes School on Woodman Road.
- MAY 3 VMSC Rally by Rallymasters Bill and Judy Chvala.
- MAY 16&17 VMSC Autocross Weekend at the Crewe Airstrip. OD's Bill and Shelia Hunter and Gary and Barbara Stout.





VIRGINIA MOTOR SPORT CLUB PRESENTS

YOUR MOTHER WOULD LIKE THIS RALLY

**SUNDAY
MARCH 29,
1981**

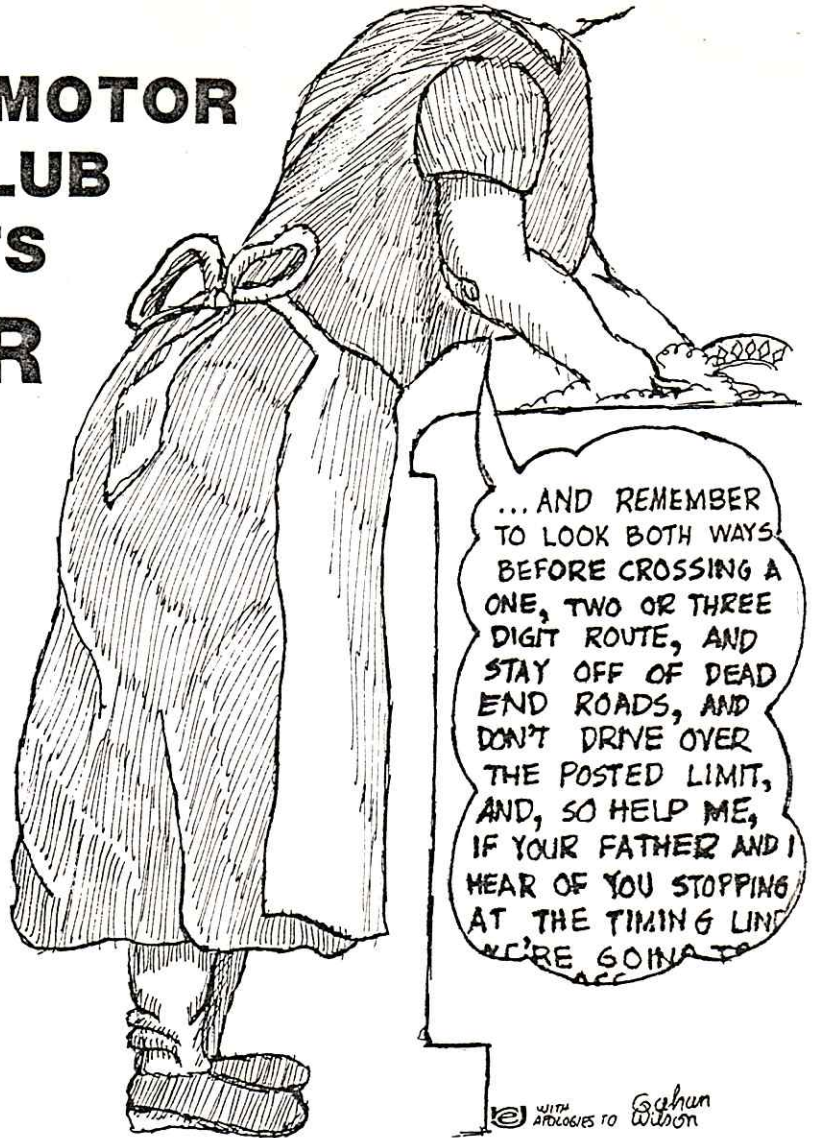

... AND REMEMBER
TO LOOK BOTH WAYS
BEFORE CROSSING A
ONE, TWO OR THREE
DIGIT ROUTE, AND
STAY OFF OF DEAD
END ROADS, AND
DON'T DRIVE OVER
THE POSTED LIMIT,
AND, SO HELP ME,
IF YOUR FATHER AND I
HEAR OF YOU STOPPING
AT THE TIMING LINE
YOU'RE GOING TO
GET IT

A very simple rally for beginners!

Starts and ends at Tuckernuck Shopping Center on Rt. 250 (Broad Street) west of Parham Road.
Total length is approximately 75 miles. No dirt.

Registration opens at 11:00 a.m. First car off at 12:31.

Cost - \$6.00 per team -- entries limited to unequipped and rookie classes only (no computers permitted).

Expanded Trophy Positions -- one trophy and/or dash plaque awarded for every five cars in a class.

For pre-registration call 804-288-0174.

A drawing for starting numbers will be held on Friday, March 13 for those who have registered prior to that date. (After March 13, you will be assigned the earliest available number upon pre-registering)

All equipped teams are invited to the gala \$2.00 per-team-winner-take-all-official-pre-check-challenge run to be held on Sunday, March 8 (Snow date March 22). Contact either rallymaster for details (or just show up on March 8 at 11:30 with your computer and \$2.00).

Novice crews requiring additional information or advice may contact the Rallymaster by calling:

Dick Jones -- 804-784-4373

Gary Stout -- 804-288-0174



PRESENTS

BUT PARKING LOTS ARE NOT FOR PARKING, HONEY!

April 5, 1981

Chesterfield Mall
(Intersection of Rts. 60 & 147
in Chesterfield County)

-- OD's --

Registration & Tech -- 10:00 a.m.

Libby Wells -- (804) 275-8772
Barbara Stout -- (804) 288-0174
Shelia Hunter -- (804) 883-6557

First Car Off -- 11:00 a.m.

\$6.00 for 3 runs

1980 MWCSCC classes modified to include camber compensation on swing-axle cars, roll over protection on open topped cars, and 1.75" minimum ground clearance.

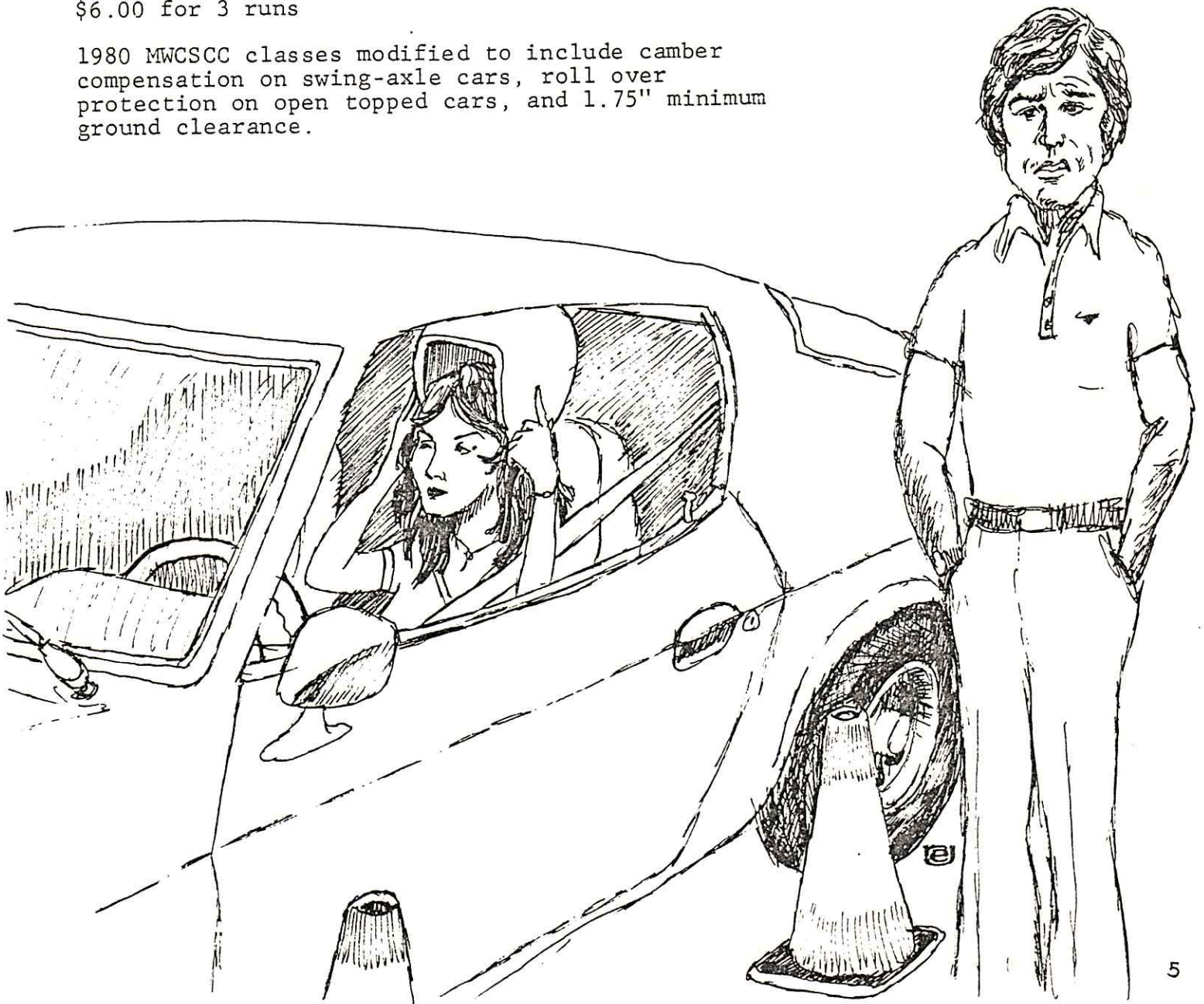

Event Result Report

Name of Event The Glass Jaw # of Entrants 20 @ \$6.00, @ \$ ____ . Date of Event February 22, 1981

O.D.'s Chris Young, Lil Young Helpers Off. Pre-check - Scott Powell, Neale Dickinson; Pre-Check - Gerry Eberhard, Doug Burton, Jeff Rickman*; Helpers - S. Powell, N. Dickinson, G. Eberhard, D. Burton, J. Rickman*, Lindsay Wilson, Annie Wilson, Shirley Zanner, Brenda Crouch*, Rhonda Kelly*, John Adams, Sue Adams, Ellis Wimmer, Janice Wimmer, Marvin Mills, Roe DeGrace,

O/A	Class Pos'n	Car #	Make	Driver	Navigator	Emilie Sikora, Toby Williams, Bill Whitehead, Aubrey Burton*														TOT.
						1	2	3	4	5	6	7	8	9	10	11	12	13	14	
1	1E †	11	Datsun	Len Wells	Tom Biot	4	0	0	1	4	0									9
2	2E †	13	Honda Accord	Peter Wilson	John DeBratelebo	0	1	3	0	3	3									10
3	3E	12	Honda Accord	Marvin DeBratelebo	Fred DeBratelebo	1	2	3	1	5	2									14
4	4E	1	Porsche 914	Gordon Wagner*	Pita Wagner*	4	36	21	53	2	0									116
5	5E	3	Honda Prelude	Gary Stout	Dick Jones	2	1	25	74	4	16									122
6	6E	7	Datsun	Bookie Westbark	Bill Armstrong	9	7	200	13	3	63									295
7	1U †	5	Volvo	Lewis Parsley	Barbara Parsley	17	37	94	113	17	95									373
8	2U †	15	Toyota Celica	Ray Milligan	David Milligan	4	115	200	34	20	8									381
9	7E	14	VW Jetta	Charlotte Hoetzel	Chuck Hoetzel	2	175	200	2	6	8									393
10	3U	4	Honda Civic	Barbara Stout	Linda Jennings*	5	8	200	7	14	200									434
11	4U	6	Mazda RX-7	Chuck Dnbrey	Alan Armstrong	2	200	200	6	5	23									436
12	5U	10	Datsun	Beth Mills	Floyd Mills	33	143	200	29	35	49									489
13	1R †	17	Ford XVR	Jeff Wright	John Matthews*	41	92	39	115	133	189									609
14	6U	16	Porsche 928	Bill Chvala	Judy Chvala	57	84	117	200	52	126									636
15	7U	2	Audi Fox	Libby Wells	Shelia Hunter	13	200	200	200	15	16									644
16	2R †	9	Toyota	Mike Newsome	Christie Simmons	15	200	200	81	54	200									750
17	3R	22	MGB	Murcen Novack*	Allen Brown	61	200	200	8	200	186									853
18	4R	8	Datsun 280ZX	Mike Bradstock*	Barbara Cook*	150	200	200	77	70	200									897
19	5R	23	MGA	Jeff King*	Carol King*	22	200	200	200	200	200									1022
20	8U	19	Chevrolet Monza	Chuck Edwards	Kathleen Edwards	23	200	200	200	200	200									1023

Deliver 1 copy to each of the following within 1 week of the close of the event: Club Secretary, Editor of Checkpoints, and non-club member participants.

* Denotes non-member of VMSC † Denotes trophy winner

THE GLASS JAW

The last thing I wanted to do on Sunday, February 22, was to run a rally. Its bad enough to run one of Chris Young's rallies when you don't know what you are doing but its even worse to run with Lewis if such is the case. However, since we had pre-registered and received the generals well in advance, I made up my mind to at least leave the house feeling somewhat prepared.

After reading the Generals and having Lewis explain the "main road" rule to me at least 50 times, we were on our way. Imagine my surprise when I learned that I had figured out the first trap correctly! Wonders never cease!

From the first control on, I felt that the rally was all downhill. Lewis and I were still speaking in complete sentences even after a few precarious moments. The only time I was overly concerned was when we came into Control # 3 doing about 80 MPH. That will really get your attention!

As we cruised along, I silently praised myself for acting like a real ralliest. I felt I had finally captured the logic of the sport even though I did forget to bring my calculator. Oh well, a navigator can't remember everything! It was shortly before the last control that I realized that the only thing I knew about a pause was how to spell it! Thanks to the fleet fingers of Lewis, Tom Blot's calculator, and an understanding motorist on Route 10, we managed to make the last control with little penalty.

In looking back on "The Glass Jaw", I can safely say that the biggest problem that this team encountered was which one of us was going out to buy lunch. I thoroughly enjoyed the event and wish to congratulate Chris and Lil for a job well done. I especially enjoyed winning my first ever VMSC Trophy. What a way to end a day!

- Barb -

The "Glass Jaw" was our first rally as Rallymasters since 1973 and we plan now not to wait so long before staging another. The rally was different in every way from those we had done before, incorporating ideas from many places and many times. We were pleased with the turnout and the reception given the rally. Many thanks to the workers who had to put up with last minute equipment failures. A note to all - Don't get bottled up in the "Glass Jar"!

— Chris —

SPARE PARTS
CLOSE-OUT SALE

1. Front End Links for Stabilizer Bars - Two (2) new, in package w/rubbers. \$10.00 for pair
2. Original Equipment Front & Rear 280 Z Sway Bars \$20.00 for pair
3. 1976 280Z Hubcaps, set of four, like new \$40.00 for set
4. 1976 280Z Stock 5½" Steel Wheels w/Michelin XVS 185/70 tires, mounted & balanced - good autocross or rally tires, some tread \$65.00 for set of four.
5. Haynes Repair Book - 240Z, 260Z, 280Z, like new \$5.00
6. 280Z Front Valence Side Panels - #301 Metallic Brown \$20.00

Patrick N. McAllister

Home : 794-6950
Office: 233-9228

HEY

When you come to the VMSC monthly meetings, get in the habit of writing your name on a dollar bill and putting the bill in the box near the door. A drawing will be made from the box at the meeting's end for a useful prize. The proceeds will go to the club.

This month's prize is a tachometer-dwell meter and an inductive timing light.



CHANGES TO THE COMPETITION REGULATIONS

1. Adopt MWCSCC autocross vehicle classes without alteration and incorporate them into the section titled VMSC Autocross Classes.
2. Add to Par 7.4.1 0. ...except Pirelli P7 which is legal in the Prepared Class. A recap Pirelli P7 is a racing tire.
3. Add to Par 10.A;
"O.D.'s (Autocross-Not Competing).....800"

PROBLEM OF THE MONTH CONTEST
MARCH PUZZLE

This month we move away from the strictly mathematical rally oriented puzzle and enter the realm of puzzles that have no relation to anything practical. The only redeeming value of these puzzles is that they are good exercises in logic. (and fun)

Most of you are probably familiar with the first group of puzzles, so a long explanation of them will not be provided. The contents of each box can be translated into a familiar phrase or saying. Each correct solution will be worth two (2) points, plus one point for sending in the solutions for a total possible 25 points. Each box is identified by a letter (at the top) and a number (on the left). Please use these identifiers with your solutions.

	A	B	C	D	E	F
1	right=right	house prairie	goodbye	milk	c c garage r r	c o m i c
2	L u e c l i	clou	ieieeieie	neegr geren ngree regen	t i o n a i n l f	pölkä

These puzzles are simply long-division problems in which letters have been substituted for the numbers 0 to 9. Each occurrence of a letter within a puzzle stands for the same number. No two different letters within a puzzle can stand for the same number. There is a different code for each puzzle. Each puzzle will be worth five (5) points for a correct solution, plus one point for sending in the solutions, for a total possible 16 points.

<p style="text-align: center;">T I C</p> <p>T R O T U N I C O R N</p> <p style="text-align: center;"><u>U R T O I</u></p> <p style="text-align: center;">I I U K R</p> <p style="text-align: center;"><u>T R O T</u></p> <p style="text-align: center;">C C U Y N</p> <p style="text-align: center;"><u>I T H T U</u></p> <p style="text-align: center;">K N Y T</p>	<p style="text-align: center;">S E E</p> <p>R E I N R O U S I N G</p> <p style="text-align: center;"><u>R O O O I</u></p> <p style="text-align: center;">B U F N</p> <p style="text-align: center;"><u>B F E U</u></p> <p style="text-align: center;">B N U G</p> <p style="text-align: center;"><u>B F E U</u></p> <p style="text-align: center;">N I B</p>	<p style="text-align: center;">S A D</p> <p>F L I T F O I S T E D</p> <p style="text-align: center;"><u>F F E F F</u></p> <p style="text-align: center;">E L N A E</p> <p style="text-align: center;"><u>E L N L T</u></p> <p style="text-align: center;">E O D</p>
--	--	---

Send your solutions to one of the editors at the addresses shown on the back cover. Your solutions must reach the editors no later than Wednesday, April 1, 1981. Be sure to include your name and address with your solutions.

SOLUTIONS TO THE FEBRUARY PUZZLES

The two February problems were intended to be fairly easy. However, it seems that I should have tried to solve them before they were published, rather than after. Each problem was intended to be treated as a continuous rather than stepped function, but after working on them for a while, I discovered that the solution to the first problem required a knowledge of integral calculus. Therefore, solutions based on continuous or stepped functions are acceptable, along with a fair amount of leeway on the times given.

PROBLEM (1): Continuous Function - This solution (as mentioned) requires calculus, which I will not go into here. However, the equation that is left after all the manipulations are done is:

$$T = \frac{1}{A} \ln\left(\frac{V_i}{V_f}\right)$$

V_i = Initial Speed (42 MPH)
 V_f = Final Speed (20.2 MPH)
 A = Acceleration (5 MPH/M)

T = Time in Hours (0.146398 Hours), which gives an ET of 8.78 minutes.

Stepped Function - This simply involves the tedium of computing the time for each 0.10 mile step up to 4.30 miles, and the time for the remaining 0.06 miles, and adding them all together. Rounding off each step to the nearest hundredth, or rounding off at the end gives the same result - 8.71 minutes.

PROBLEM (2): Continuous Function - The solution to this problem is based on the equation for the distance traveled by an accelerating body. This equation is:

$$D = V_i T + \frac{1}{2} A T^2 \quad \text{Which becomes:} \quad T = \frac{-V_i \pm \sqrt{V_i^2 + 2AD}}{A}$$

D = Distance (4.36 Miles); V_i = Initial Speed (42 MPH); A = Acceleration (200MPH/H); and T = Time in Hours (0.187639 Hours), which gives 11.26 minutes.

Stepped Function - This simply involves the tedium of computing the distance traveled for each 0.15 minutes at the different speeds, and the time to travel the last little distance, and adding up all the times. If the distances were rounded off to the nearest hundredth of a mile for each computation the ET is 10.43 minutes. If the distance is not rounded off the ET is 10.75 minutes.

Another method of solving the Stepped Function is by using a summation equation. This method would take too much space if I included it here, but the result is the same as the non rounding method above - 10.75 minutes.

If anyone has any questions about how I arrived at these answers, or if you are interested in the methods not fully explained here, just ask me. (AJA)

***** NEXT MONTH THE STANDINGS IN THE CONTEST WILL BE PUBLISHED *****

FOR SALE
 1967 Plymouth Fury I.
 Excellent gas mileage (10 to 15)
 Few rust holes.
 Mechanically sound.
 Call Alan Armstrong 232-8252
 (cheap \$400) \$3500

E. G. Bradley Inc.

"RICHMOND'S EXCLUSIVE TRIUMPH DEALER"
FEATURING

SCCA NATIONAL CHAMPIONS



TRIUMPH SPITFIRE 1500

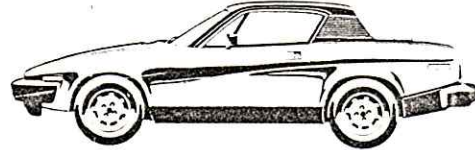

Triumph TR7

10% Off Parts & Service To VMSC With This Ad

E. G. BRADLEY INC.
621 W. MAIN ST.
RICHMOND VA.
648-7255
VA. DLR. 227



E. G. BRADLEY

Fin & Feather

PET CENTER INC.



PUPPIES

FISH

BIRDS

AQUARIUMS

Supplies for all pets

Grooming and Clipping

Small animals boarded

DISCOUNTS TO

VMSC MEMBERS

Hours:

10-8:30 Mon. - Fri.

10-6 Sat.

5208 LAKESIDE AVENUE



PHONE
262-6681

